

Rohs Compliance

REV	DESCRIPTION	DATE	BY

DIRECTION OF ROTATION

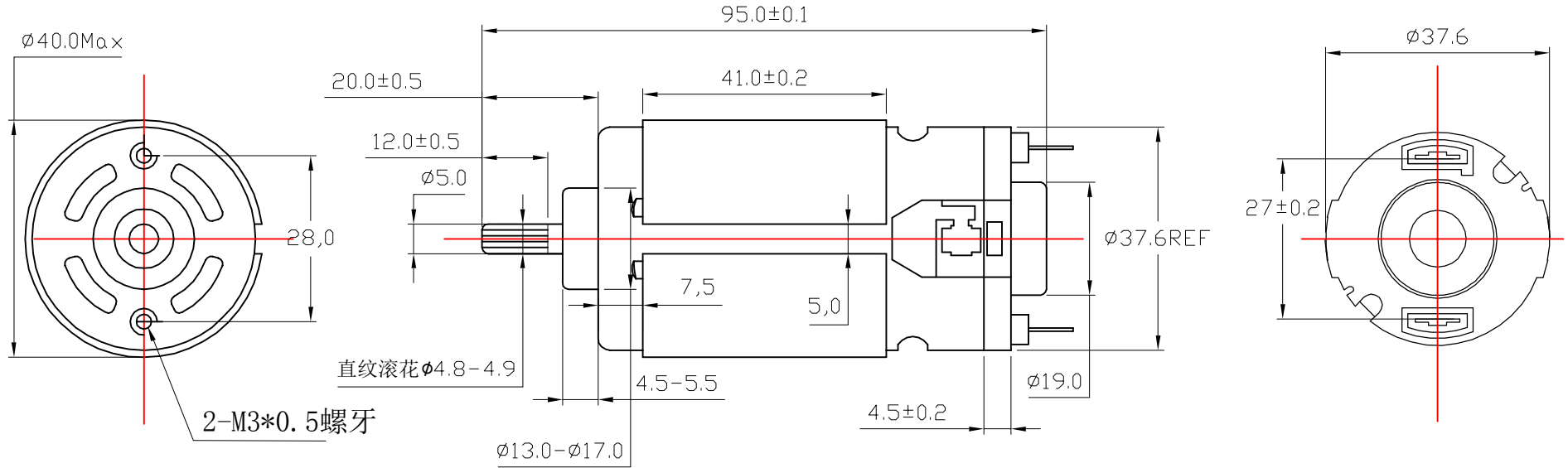

Notes:

1. Voltage with Frequency (电压和频率): 230V/50Hz--DC
2. Rotation (转向): CCW
3. No-load Performance (空载性能)
 No-load Speed (空载转速): 14000±10%
 No-load Current (空载电流): <0.1
 No-load Power (空载功率):
4. load Performance (负载性能)
 load Speed (负载转速):
 load Current (负载电流):
 load Power (负载功率):
5. Withstand Voltage (耐压): 1500V/1Ma/1Sec
6. Lock Torque (堵转扭矩): 2.8KG. CM
7. Lock Current (堵转电流): > 1.4A

CIRCUIT DIAGRAM:

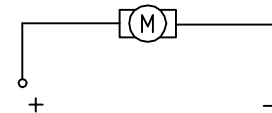

Label content:

OD-5512D230-2
MADE IN CHINA

GENERAL TOLERANCES ISO 2768-m	
Permissible deviations for linear dimensions	
Permissible deviations for basic size range	
>0.5 ...3	>3 ...6
>6 ...30	>30 ...120
>120 ...400	>400 ...1000
>1000 ...2000	>2000 ...4000
m ±0.1	±0.2
±0.3	±0.5
±0.8	±1.2
±2	

Permissible deviations for angular dimensions		Permissible deviations for broken edges (external radii chamfer heights)	
>0.5 ...10	>10 ...50	>0.5 ...3	>3 ...6
>50 ...120	>120 ...400	>0.2 ...0.5	>0.5 ...1
m ±1°	±0°30'	±0.2	±0.5
±0°30'	±0°20'	±0.5	±1

DWN. BY	CHK. BY	APP. BY
Date(yyymmdd)	Date(yyymmdd)	Date(yyymmdd)
MATERIAL:		<input checked="" type="checkbox"/> SCALE 3:1 <input type="checkbox"/> NOT SCALE
FINISH:		
General Tolerance ISO 2768-1 Class m (Unless specified)		TITLE
ALL DIMENSIONS ARE IN MILLIMETRES		OD-5512D230-2
SHENZHEN ODIN IMPORT AND EXPORT CO., LTD		DWG NO.
		OD-5512D230-2
		SHEET 1 OF 1